



# ANNUAL FLYING STARS FENG SHUI REPORT

Name: Mr. A

Address: No 2A, Jln 34/56A,  
Casa Prima 6,  
Subang Jaya, 55100,  
Selangor.



[WWW.JOEYYAP.COM](http://WWW.JOEYYAP.COM)

1. INTRODUCTION
2. THE NATAL CHART OF YOUR PROPERTY
3. ANNUAL FLYING STARS CHART FOR 2009 FOR YOUR PROPERTY
4. FLYING STARS AFFLICTIONS FOR 2009 FOR YOUR PROPERTY
5. AFFLICTED SECTORS OF YOUR PROPERTY FOR THE YEAR
6. 8 SECTORS OF YOUR PROPERTY – WITH A SECTOR-BY-SECTOR ANALYSIS, USING THE NATAL FLYING STARS CHART OF YOUR PROPERTY AND THE ANNUAL FLYING STARS FOR 2009.
  - NORTHEAST
  - NORTH
  - NORTHWEST
  - WEST
  - SOUTHWEST
  - SOUTH
  - SOUTHEAST
  - EAST
7. WATER PLACEMENT FEATURES FOR YOUR PROPERTY FOR 2009
8. GENERAL ADVICE FOR THE YEAR
9. SUMMARY OF YOUR FLYING STARS REPORT

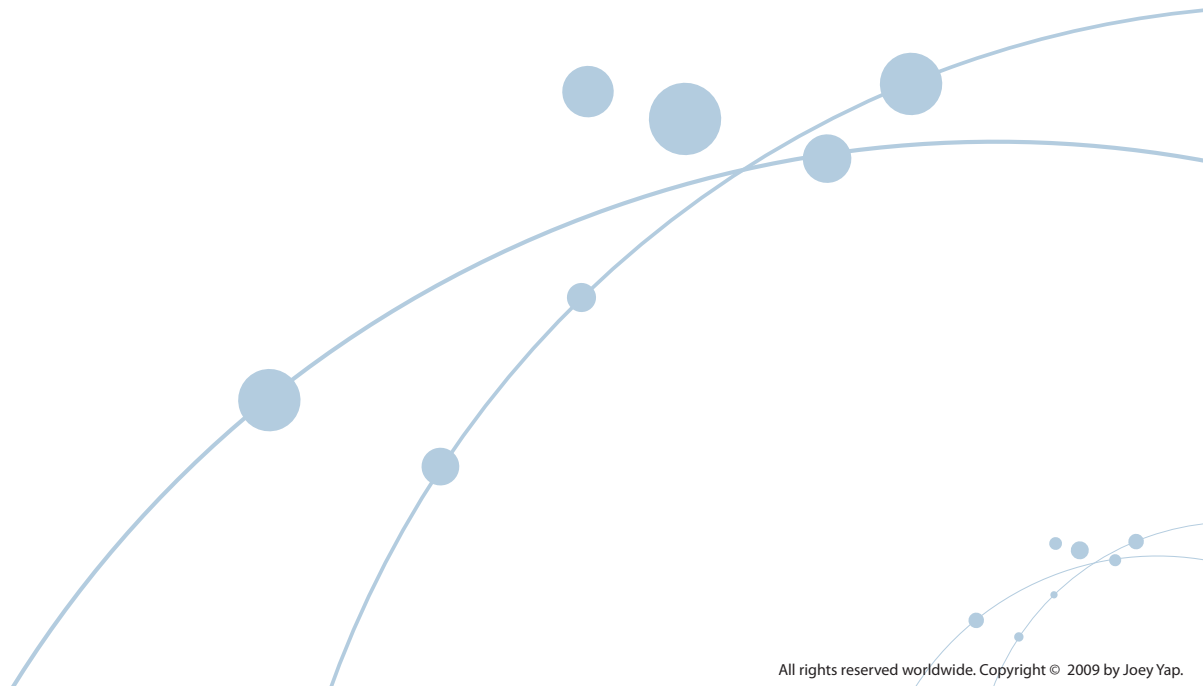

All rights reserved worldwide. Copyright © 2009 by Joey Yap.

## **This Annual Feng Shui Flying Stars Report will provide you with:**

- The Natal Chart of your Property
- Annual Flying Stars Chart for 2009 for Your Property
- Flying Stars Afflictions for 2009 for Your Property
- Afflicted Sectors of Your Property for the Year
- 8 Sectors of Your Property – with a sector-by-sector analysis, using the Natal Flying Stars Chart of your Property and the Annual Flying Stars for 2009.
- Water Placement Features for Your Property for 2009

This report is personally tailored to your property for the year 2009 and will highlight the important areas of your property and provide you with a Flying Stars analysis of each individual sector. This will furnish you with all the relevant Feng Shui information you need for your property for this year, providing you with a solid base from which you can attempt to make changes in your life for the year ahead.

This report is modeled after Joey Yap's professional Xuan Kong Flying Stars Feng Shui techniques and methods, similar to those used for his on-site Feng Shui consultations and audits.

## What this Report Can Do For You

Feng Shui is essentially the art of evaluating and assessing your quality of life through the observations and analysis of your living environment. The aim of Feng Shui is to tap into the Qi (cosmic energies) of the living environment to enhance the quality of life.

Qi simply refers to the body of energy that exists in the natural world. Qi is not man-made, or reproduced through artificial means. It is the naturally-occurring energy that exists in the world. Feng Shui is about harnessing and tapping into that Qi in order to improve one's quality of life and to allow for one's deepest potential to flourish.

This report provides you with an outlook of the Feng Shui of the property for the year ahead. It will primarily focus on the key features of your property, which include the Main Door, Master Bedroom, and Kitchen, as well as any other secondary bedrooms you may have. It will also provide an outlook on the remaining sectors of your house.

The advice in this report is designed to provide you with an insight into the potential of your property, but do bear in mind that it might affect the different occupants of the house in different ways. You should use this information and act upon the suggestions contained within it to capitalise on any positive potential it confers, as well as manage and reduce the effect of any possible negative implications that might exist.

For example, if the outlook for your Master Bedroom indicates a potential for arguments between the occupants, knowing this information can provide you with some steps and measures to take. You can choose to use another room in a different sector for the year, if this option is available to you. Or you may choose to focus on strengthening the relationship ties with your spouse or partner to prevent or lessen the effects of disharmony. Alternatively, you may choose to go away on a holiday with your partner in order to work on improving the relationship.

The advice provident in this report, functions as a guide - it's up to you to make the most of it. A negative reading, need not be approached with pessimism, prepare for it - the same way you would bring an umbrella when the weather report predicts rain.

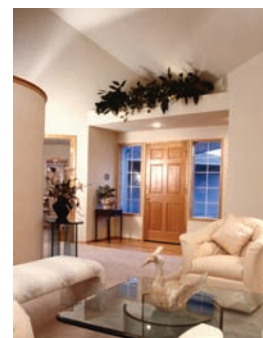
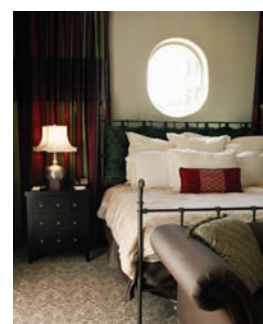

## How This Report is Derived

There are two key fundamentals we are looking at, in order to assess the Feng Shui potential of your property.

The first is the Natal Chart of your property. The second is the Annual Flying Star Chart for the year.

### Describe Natal Feng Shui Chart:

The Natal Flying Stars Chart is the fixed Flying Stars chart for your property. As much as a person will have a BaZi Destiny Chart upon his or her birth, a property will likewise have a Flying Stars Chart. The Natal Flying Stars Chart of your property is determined by year of construction and facing orientation, and it is fixed and unchanging, unless your property has been extensively renovated.

### Describe Annual Feng Shui Chart:

The Annual Stars, meanwhile, are the Stars that fly into your property and change on a yearly basis. These Stars are not static or fixed, and move into different sectors of your property for each different year. They act as catalysts to the potential of the Flying Star Combination of a property's Natal Flying Stars Chart.

The Natal Chart is the fixed chart of your property for a period of 20 years. It is the potential that is inherent within the property. The Annual Stars that fly in to the individual areas and sectors act as catalysts for the sectors in that property, thereby allowing you to know which sectors can be enhanced and improved, and which areas should be left undisturbed or unused.

This report considers the Facing and Sitting stars within the Natal Chart of your property, and how it interacts with the Annual Flying Stars that fly into the various sectors of your property. With this report, you will be able to ascertain the effects of the interaction between your property's Natal Chart (which is unchanging) and the Annual Flying Stars (which changes on a yearly basis) to determine the best way to utilise your property's potential.

Knowing this, you can utilise this information to improve various aspects of your life. For example, if you know that your secondary bedroom is within a sector that is good for studies and for work, and helps increase productivity, you have the option of using that room as your study or workspace for the year.

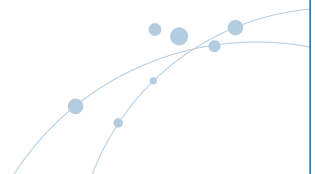

## How to Superimpose the Natal Flying Stars Chart onto Your Property's Floor Plan

A few important steps will help to ensure that you correctly superimpose the Natal Flying Stars Chart onto your property's floor plan.

- 1) The first step will be to divide your property according to the 9 grids. On the plan of your house, draw or trace over the 9 Grids as illustrated.

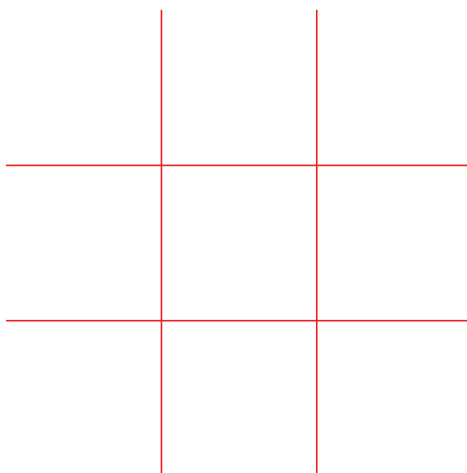

- 2) Having determined the Facing of your property earlier, demarcate the rest of the property according to the 8 different sectors using the 9 Grids. Please note, the Natal Flying Star chart below is only an example. Please refer to your own property's Natal Flying Star Chart on pages to superimpose this on your property.

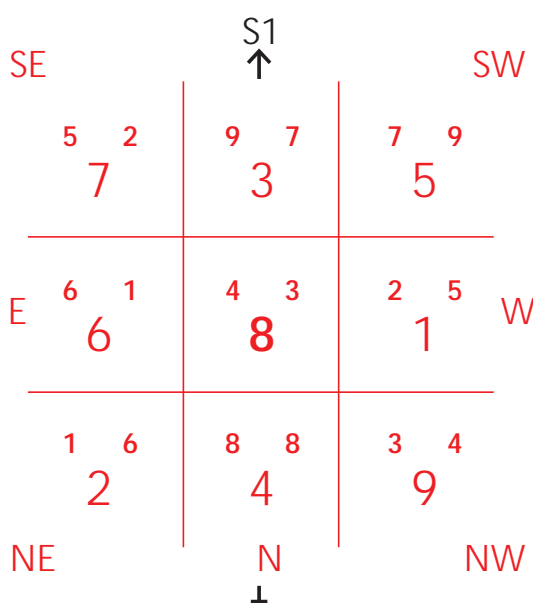

# NATAL FLYING STARS CHART

3) Use the 9 Grids and superimpose it over your house plan to enable you to demarcate your property into the sectors.

## Example 1:

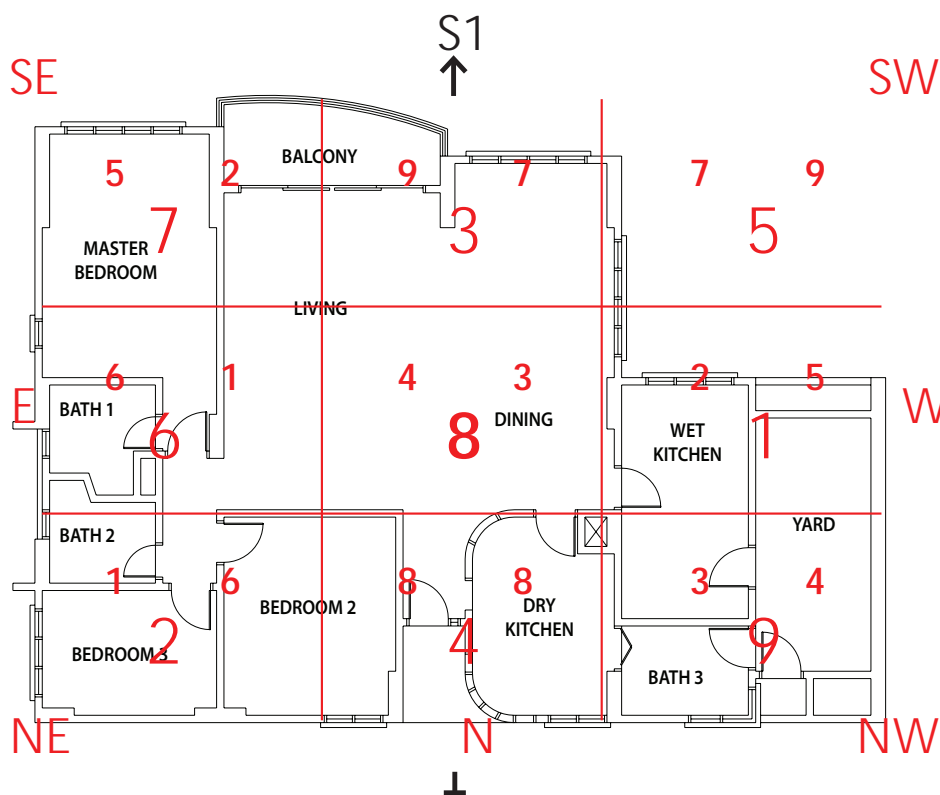
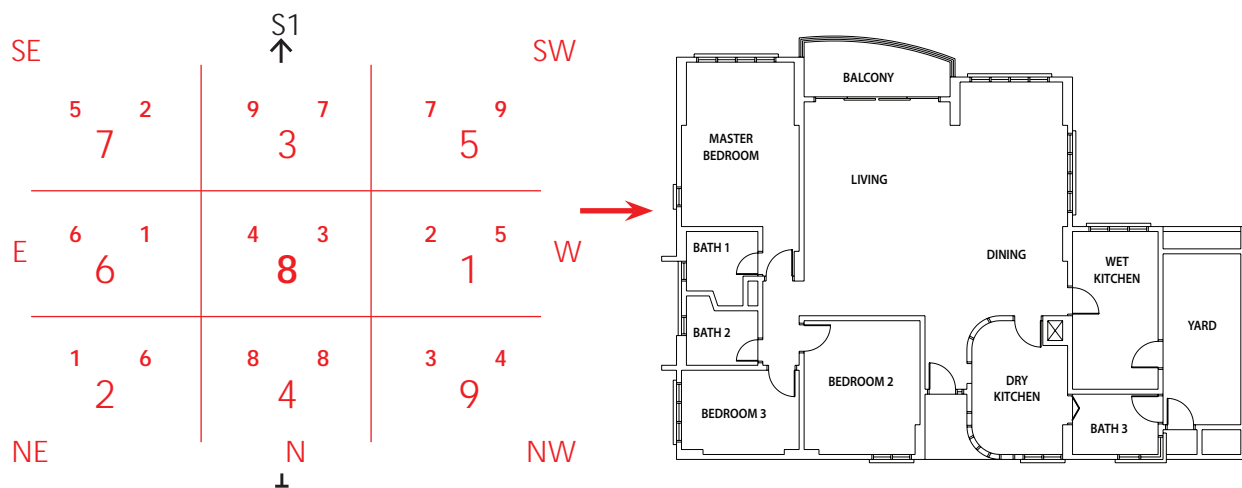

# NATAL FLYING STARS CHART

## Example 2:

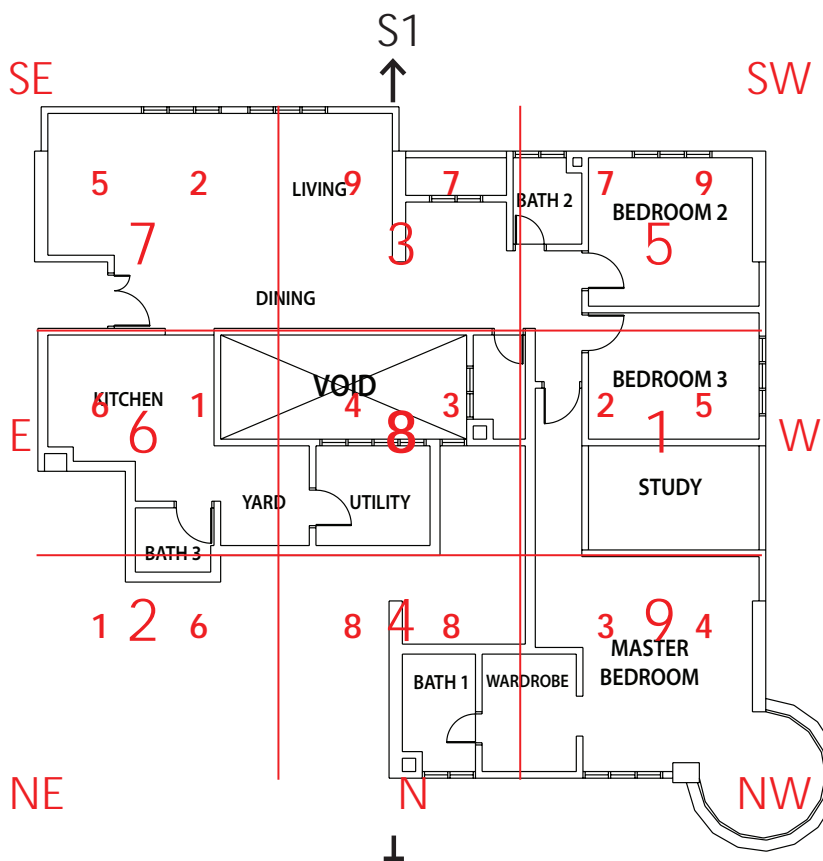
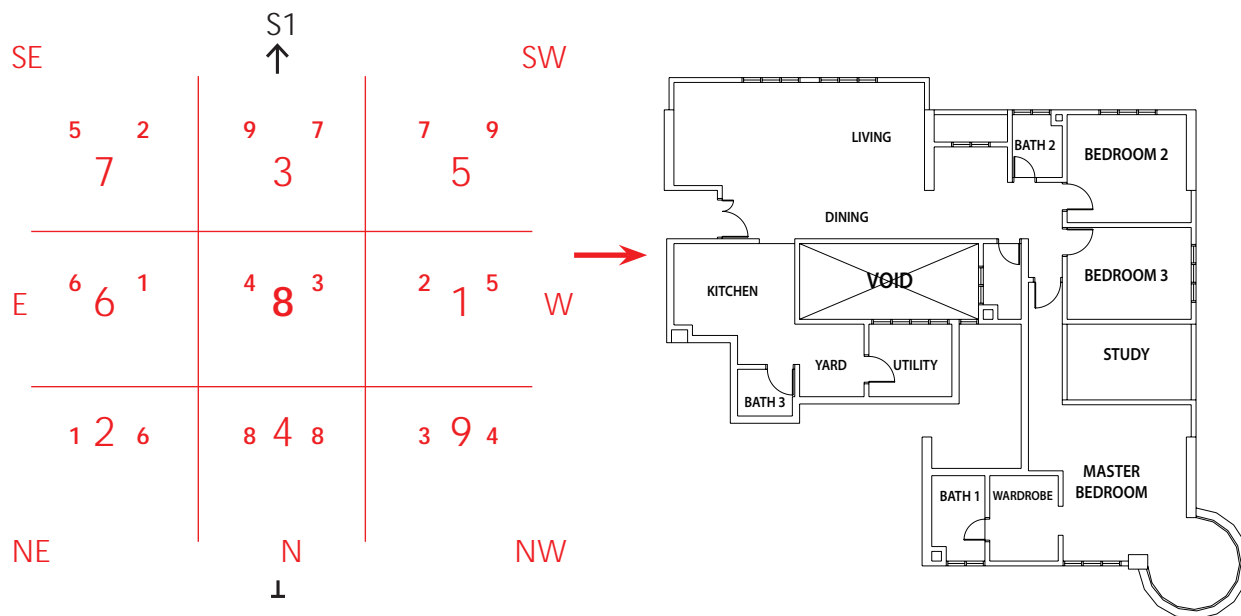

### Note:

If your house is an L-Shaped or T-shaped house, or is in general an irregular-shaped house, then certain portions of this Report may not apply to your property. This is because if more than 1/3 of any of the horizontal or vertical grid spaces is missing, then the property is regarded as having a missing sector.



# ANNUAL FLYING STARS CHART FOR 2009

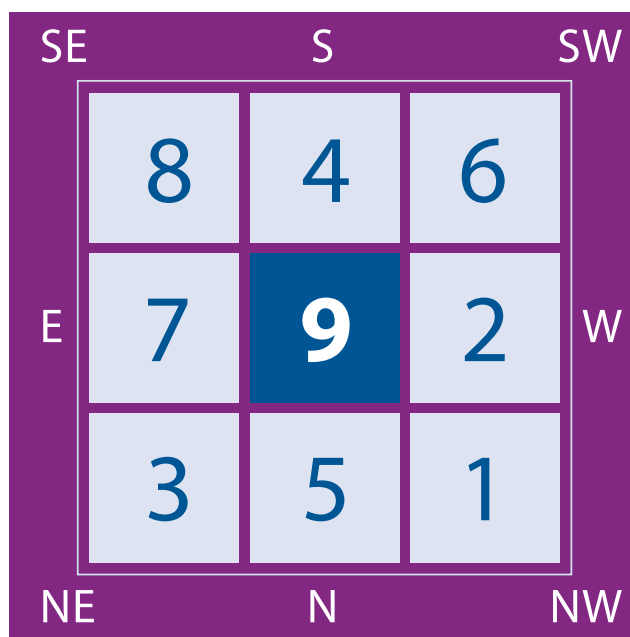

This chart shows the Annual Flying Stars chart for your property. This Annual Flying Stars chart is valid only between February 4, 2009 and February 4, 2010.

In 2009, each of these individual stars fly into the relevant sectors of your house. Below is an explanation of the individual stars in the respective sectors, as well as the Flying Star Afflictions for 2009:

Southeast	<b>8 White</b>	For this sector, the #8 White Star flies into place for the year. As such, it is considered to be the Wealth sector of the year for your property. If your home has a Main Door located in this area, you can expect some positive benefits such as good potential for wealth and financial returns, as well as prospective career advancement. For that reason, it is recommended that you activate this sector and use it as often as possible. Renovations are encouraged for this particular sector. Bear in mind that you can still tap into the positive energies of the #8 White in this sector by tapping into the direction; either by using it extensively, or placing a Yang-type object in the area like an aquarium, or even fans, clocks, and televisions.
-----------	--------------------	--

South	<b>4 Green</b>	This sector of your property sees the #4 Green Star fly into place for the year. The #4 Green is particularly beneficial for scholarly and academic pursuits. As such, the occupants in your house who use this area will excel in their studies or scholarly pursuits. If you have academics, researchers, and writers using this area in your home, they will be able to enjoy the benefits and see the positive results in their work. If you also use this sector as your workspace or use it fairly frequently, you can expect to do some travelling. Couples using this area will see an improvement in their relationship and will enjoy better ties.
-------	--------------------	--

# ANNUAL FLYING STARS CHART FOR 2009

Southwest	<b>6 White</b>	The #6 White Star flies into this sector for the year. The presence of this star generally bodes well for professional activities, especially if you want to gain greater recognition at work or climb the career ladder. It will be best to use this sector frequently in your home throughout the year in order to see the positive impact in your work. However, do bear in mind that while the energies of the #6 White Star are generally good, you should be aware of potential health complications involving your kidneys and legs. Also, sudden changes are also possible with this star, so be on the alert for this, especially where your career is concerned.
-----------	--------------------	--

East	<b>7 Red</b>	This sector of your home sees the #7 Red Star fly into place for the year. This star can bring about volatile emotions, and thus bring about possible arguments. For people with existing health troubles or complications, it could suggest possible hospitalisation or surgery. If couples use this sector, they could be prone to regular disagreements and quarrels. Bear in mind that if you have a Main Door here, you could be more susceptible to robberies and loss. As such, it will be better for you take proper precautions and change or double-check your locks, and installing a security alarm system. Also, it might signify some unhealthy competition and rivalry in your career.
------	------------------	---

West	<b>2 Black</b>	The #2 Black Star is present in this sector of your property for the year. As much as possible, you should try not to use this area much. The #2 Black's influences are largely negative, and can bring about illnesses and persistent health troubles. Pregnant ladies especially should completely avoid this area, if possible. If for certain reasons you are unable to avoid using this sector, then the negative energies of this star can be lessened or weakened by placing metal objects in the area – preferably those made of brass, copper, bronze, or pewter.
------	--------------------	--

Northeast	<b>3 Jade</b>	This area of your home sees the #3 Jade Star fly into the area. This star has largely negative influences, resulting in strong disagreements and quarrels for the occupants of your house using this area. There will be a heightened sense of tension. As such, it would be best to avoid this area completely. Extreme effects of the #3 Jade also include legal complications and possible lawsuits. One way to try to lessen the effects of this star in the area, if you need to use it, is by placing an oil lamp or any bright red items in this sector for the duration of the year.
-----------	-------------------	--

North	<b>5 Yellow</b>	This is the most dangerous sector of your home for the year, as it is afflicted with the #5 Yellow Star. This area should therefore be avoided for all important activities, and where possible, it must be avoided completely. But should it be the case that you need to use this sector for any particular reason that cannot be avoided, then it is important to pacify the negative energies of this sector by placing more metal items in the area. Typically, these items should be made of brass, copper, or iron. But all renovation activities for this sector must be avoided. In light of a situation where renovation works cannot be avoided and must be pursued, then it must only be done after a good date has been carefully and thoroughly considered.
-------	---------------------	---

Northwest	<b>1 White</b>	The #1 White Star is present in this area for the year. The energies of this star are generally good, heralding new ventures, new beginnings, and generally happy and uplifting events. Couples who wish to enter matrimony or start a family will be well-advised to use this area, as the energies are beneficial for such activities. The presence of the #1 White makes this sector the secondary Wealth sector of your home for the year, so you might want to use the area more often and maybe even convert it into a home study or office.
-----------	--------------------	--

All rights reserved worldwide. Copyright © 2009 by Joey Yap.

**未**  
Wei

## SOUTHWEST 1 Year Breaker 歲破

The Year Breaker, which is also known by another name – ‘Wrath of the Grand Duke’ – comes into the Southwest sector for this year. The Southwest sector should therefore not be activated at any point. In particular, any form of renovations or groundbreakings should be avoided. Aggravating this sector or disturbing it in any way can lead to serious repercussions that can be quite severe, and these consequences can be worse than the ones brought about by the Grand Duke.

**甲卯乙**  
Jia Mao Yi

## EAST Three Killings 三煞

For this year, the Three Killings is in the East sector. This indicates that the area must not be activated or disturbed in any form. Particular activities that should be steadfastly avoided include groundbreaking or renovation activities. Otherwise, pursuing these activities can cause adverse effects for the property itself, and for the people residing in it. If the sector with the Three Killings is inadvertently disturbed, you can expect possible negative consequences that include accidents and mishaps, as well as robberies, loss of wealth, and persistent troubles and problems.

**丑**  
Chou

## NORTHEAST 1 Grand Duke 太歲

The Grand Duke is in the Northeast sector for the year, and as such this sector should not be disturbed or aggravated in any way. Otherwise, you risk disturbing the negative energies of the star. Doing so can bring about the danger of potential hazards like accidents and mishaps. There is also potential risk to the health of the inhabitants, causing some serious or untoward medical complications. It is not ideal to have to face this sector when at work or in professional settings. If you find yourself in this situation, you must remember to take the proper precautionary steps to avoid being affected by the negative energies. It will be best for you to put your back to this direction, as doing so will enable you to gain greater control at the workplace, and will guide you in making stronger professional negotiations in your career endeavours.

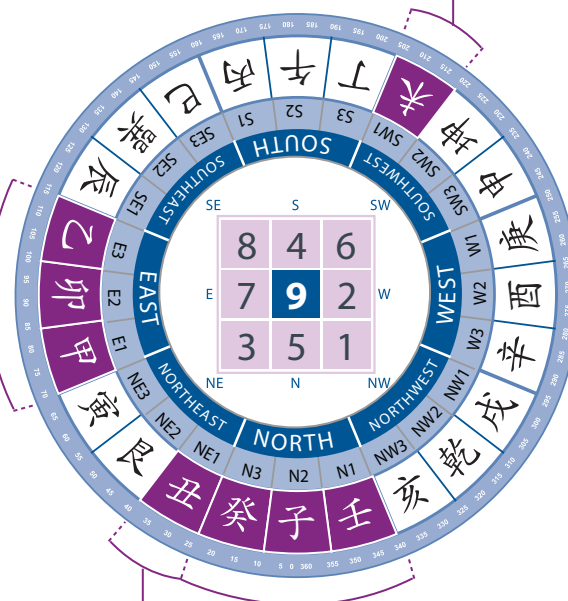

**壬子癸**  
Ren Zi Gui

## NORTH 2 Five Yellow 五黃

The #5 Yellow flies into the North sector for this year, and as such makes this the most negative sector. The North should therefore be avoided for all important activities, and where possible, it must be avoided completely. But should it be the case that you need to use this sector for any particular reason that cannot be avoided, then it is important to pacify the negative energies of this sector by placing more metal items in the area. Typically, these items should be made of brass, copper, or iron. But all renovation activities for this sector must be avoided. In light of a situation where renovation works cannot be avoided and must be pursued, then it must only be done after a good date has been carefully and thoroughly considered.

Do bear in mind that you should endeavour to sidestep or avoid any potential mishaps and problems that could be brought about by activating the sectors with the Grand Duke, Three Killings, and Year Breaker. This means avoiding any type of groundbreaking or renovation works in the area. However, if these activities are absolutely unavoidable in these sectors, then you should make the effort to select the right time and date to counter the afflictions brought upon by these stars.

For this, it would be best to refer to Joey Yap's Tong Shu Diary to make use of the guidelines provided there, and to obtain the most auspicious times and dates to conduct activities in these areas. However, to engage more specific date and time selection, it is highly recommended that you engage the services of a professional Date Selection consultant from Yap Global Consulting.

# UNDERSTANDING YOUR FLYING STARS CHART

## Your Natal and Annual Flying Star Chart

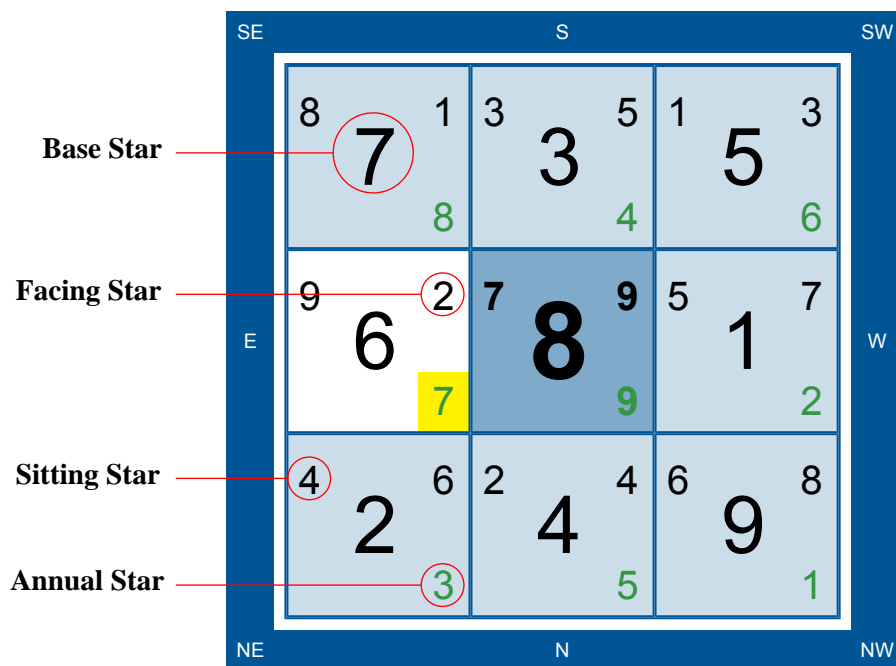

The image above is the real Natal Flying Star Chart for the house. It shows you what stars the respective numbers on the chart correspond to. The Annual Flying Stars that fly into the individual sectors are shown on the bottom right hand corner of each sector.

The Base Star, or also known as the Base Number, is determined by the Period Luck of your house.

The Sitting Star is on the left side of the Base Star. It is sometimes known as the ‘Mountain Star.’ Sitting Stars relate to Health and Relationship aspects of the occupants in a property.

The Facing Star is on the right of the Base Star, and is sometimes referred to as the ‘Water Stars.’ Facing Stars govern all matters related to Wealth and Career.

The Annual Stars are the yearly stars that fly into a given area in a property (explained in detail on p.5 of this report).

# 8 SECTORS OF THE PROPERTY

## East Sector - Your Main Door

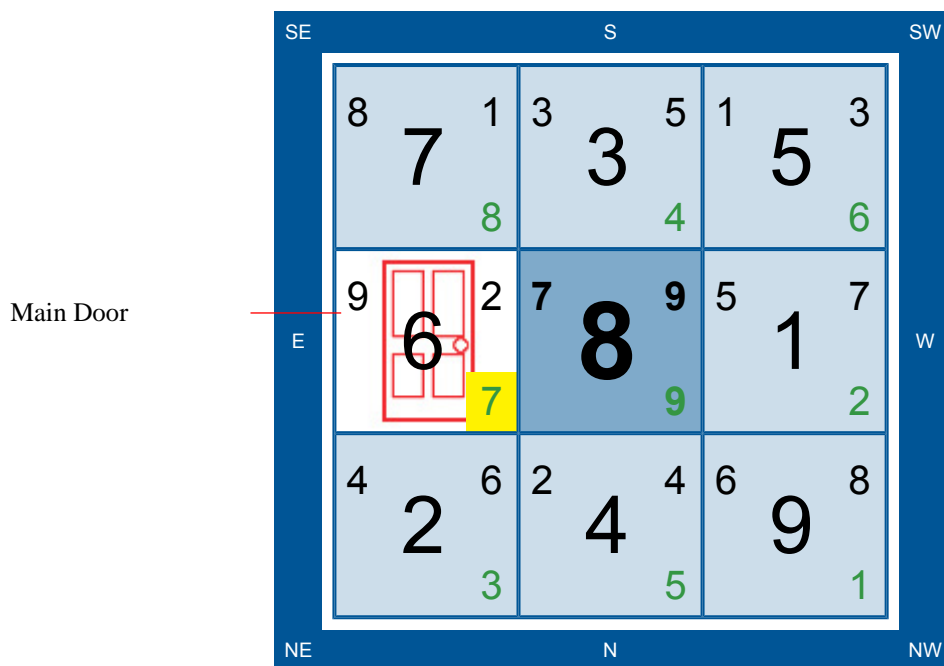

The Main Door is absolutely essential to the Feng Shui of the property, and with the Bedroom and Kitchen form the 3 most important factors of an internal Feng Shui evaluation. The importance of the Main Door is vital, It is regarded as the Qi Mouth of the House, as it is the primary entrance for Qi from the environment.

This year, the Annual #7 Star is located at your Main Door. Hence, even if your career happens to be soaring or taking-off at the moment, it is still important - perhaps even all the more important - to keep your feet firmly rooted on the ground! Continue to hone your oratory or linguistic skills, which will serve you well especially if your job requires you to interact frequently with others. Set realistic targets, and plan carefully as to how you intend to go about achieving them.

It is important that the Main Door is not negatively or adversely affected by the external Landforms in any way. This will only affect the ability of the property to receive Qi from the surrounding environment. The areas before and after the Main Door should be kept free of any obstruction, as this will block the flow of the Qi into the house or property. A good Main Door is crucial in ensuring the property can tap into the Qi in the external environment. Even the best landform would be ineffective if the property cannot receive the Qi from the hills and waterways in the vicinity.

# 8 SECTORS OF THE PROPERTY

## West Sector - Your Master Bedroom

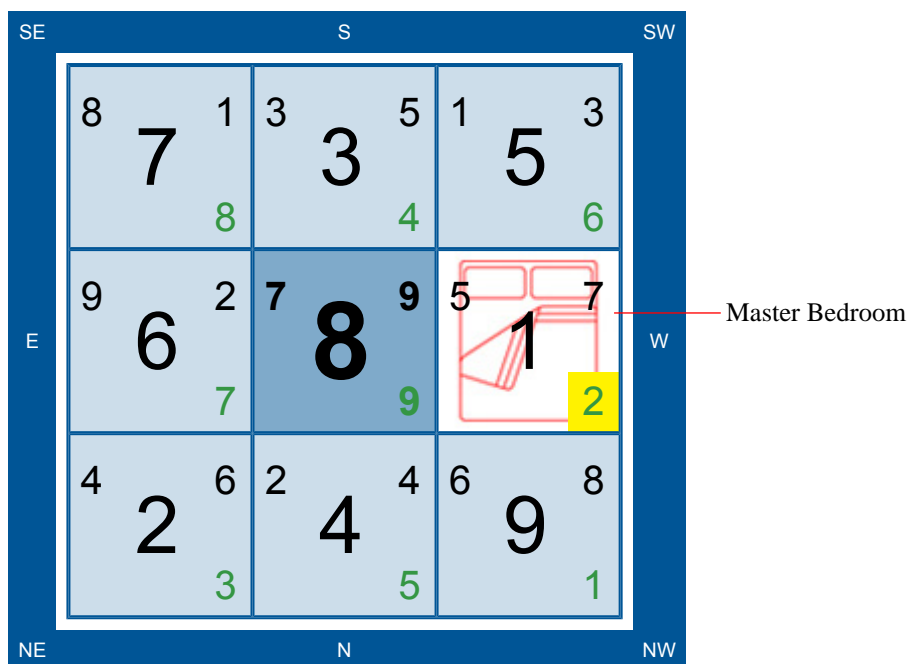

In 2009, the #2 Yellow Star is located in your West Master Bedroom.

The Bedroom is another area of importance, and this becomes evident when you realise that about 1/3 of your life is spent in this room. Sleeping and resting, both of which largely take place in the bedroom, are important activities that have a significant impact on our health, energy levels, and vitality. In evaluating the bedroom, it is important to ensure that Qi can enter the bedroom, but also to locate the bedroom in an ideal area and position the bed inside the room accordingly.

This year, the overly candid or hurtful utterances of a mother-in-law could cause domestic strife and discord, especially between married couples. Worse still, the desire to get even or seek revenge may become so strongly ingrained within one's very self, that any hope for peace may come in the form of a neutral, level-headed mediator - who is capable of bringing the conflicting parties together, to iron out their differences. It would be wise to seek to resolve any differences as soon as they arise, lest they lead to unnecessary feelings of guilt or remorse that may haunt one.

In addition, there are other factors to take into consideration when evaluating the Feng Shui of the bedroom. A general principle would be to avoid having a window behind your bed. If a window does happen to be behind your bed, then it is advisable that the window be covered with heavy blinds or curtains. Having a TV or mirror placed in front of the bed also does not bode well for the Feng Shui of the bedroom and for the occupants of the bedroom. Taking into account all these factors accordingly, together with the Flying Stars in the room, can help to ensure that the bedroom enjoys good Feng Shui.

# 8 SECTORS OF THE PROPERTY

## Southeast Sector - Your Kitchen

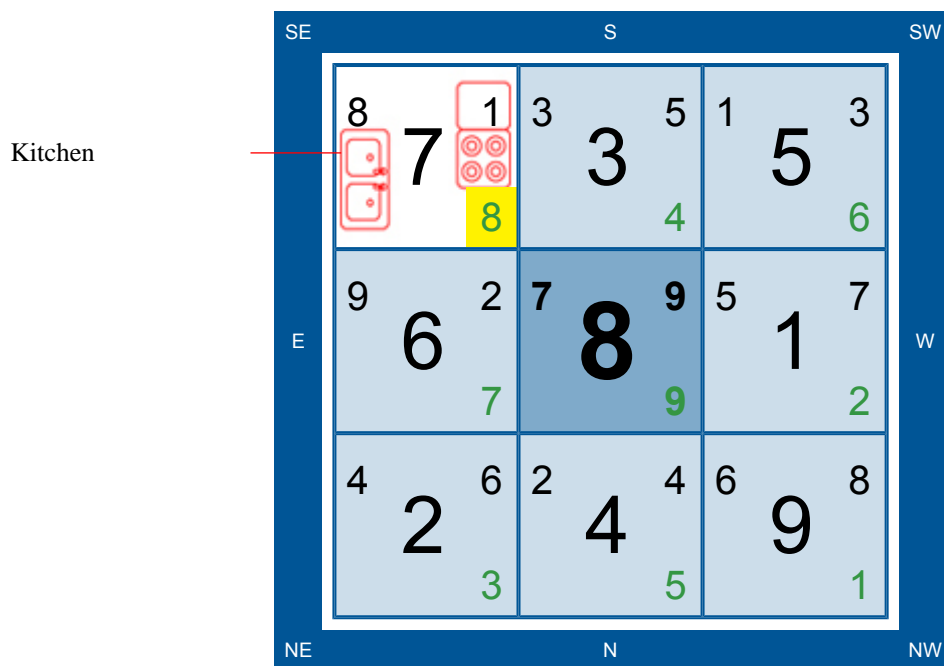

The Kitchen is an area of importance when evaluating the Feng Shui of a home simply because the food that you eat is prepared in the kitchen. If the Qi in the kitchen is bad, then the occupants of that property will not be consuming good or proper food, which can only result in bad health. A kitchen that is wrongly or even badly located typically indicates poor health or a shortened lifespan for the occupants of that property, and constant poor health may plague them.

Your kitchen is under the influence of the Annual #8 Star this year. Therefore, have any muscular cramps or stiffness referred to a doctor or chiropractor at once. Be forewarned that this combination brings with it a heightened risk of back, shoulder and even spinal-related problems; so a stitch in time may well save nine!

When applying the information above, do keep in mind that the positive aspects of your Kitchen can only be fully realised when it conforms to the internal Feng Shui. Where Kitchens are concerned, this means that there should be no sharp angles in the Kitchen directed at the stove. Also, there should not be an 'island stove' - or what is more commonly known as a stove that is located in the middle of the Kitchen. An island stove indicates an unstable stove element and having it at the centre of the kitchen exposes the stove to Qi coming in from all angles, affecting the food that you cook. Keeping these factors in mind can greatly help to improve the Feng Shui of your Kitchen.

# 8 SECTORS OF THE PROPERTY

## South Sector

South Sector

	SE	S	SW	
8	7	3	5	3
	8	4	6	
9	6	8	1	7
	7	9	2	
4	2	4	9	8
	3	5	1	
	NE	N	NW	

The South sector has the 3-5 combination in the Natal Flying Stars Chart of your home.

The Annual Star that flies into place for this sector for the year is the #4 Green Star, which when positive is a star of learning, beauty, and scholarly pursuits. It is generally a star of knowledge and being able to appreciate and enjoy the better things in life. It can also indicate a chance for travel, and promote closer ties and a better relationship for couples who use this sector. In general it can help those in academic and scholarly activities advance in their respective fields of work or study.

When read together, minor, modest gains may be expected from academic, scholastic or IQ-related pursuits, although one should not be greedy in forsaking long-term growth for immediate benefits in the form of windfall gains. Rest assured that such a move would only work to one's detriment, more so if one happens to be involved in the PR, R&D, journalistic or publications field. Ultimate success is a culmination of earlier successes on a smaller scale, so the slow and steady approach would allow one to realize one's goals and aspirations, eventually.



# 8 SECTORS OF THE PROPERTY

## North Sector

SE	S			SW					
8	7	1	3	3	5	1	5	3	
		8			4			6	
9	6	2	7	8	9	5	1	7	
E		7			9			2	W
4	2	6	2	4	4	6	9	8	
		3			5			1	
NE	N			NW					

North Sector

The North sector of your property has the 2-4 combination in the Natal Flying Stars Chart.

The Annual Star present in this sector for the year is the #5 Yellow Star, which is largely volatile, aggressive, and menacing. As such, it is seen as having negative attributes. Generally, this star brings about unfavourable outcomes that can sometimes be catastrophic. This includes fatal accidents and possible illnesses. Other manifestations of the #5 Yellow being activated include potentially damaging events like bankruptcy, betrayals within professional and personal ties, and persistent problems and major illnesses. With the presence of positive external forms, or by not triggering or activating this star, it will not pose a problem.

By combining the potential of the Natal Flying Stars Chart and Annual Star, we can ascertain that watch out for any negative forms - such as pointed rooftops, pylons or wind-gaps - lurking outside this sector, for they are the harbingers of disputes and arguments flaring up in an abrupt, unanticipated manner. It is all the more important to identify the underlying reasons or factors behind a conflict, as still waters usually run deep. The good news is that as long as everyone concerned is willing to be truthful and compromising with one another, there are few - if any - disputes that cannot be resolved amicably.

# 8 SECTORS OF THE PROPERTY

## Southwest Sector

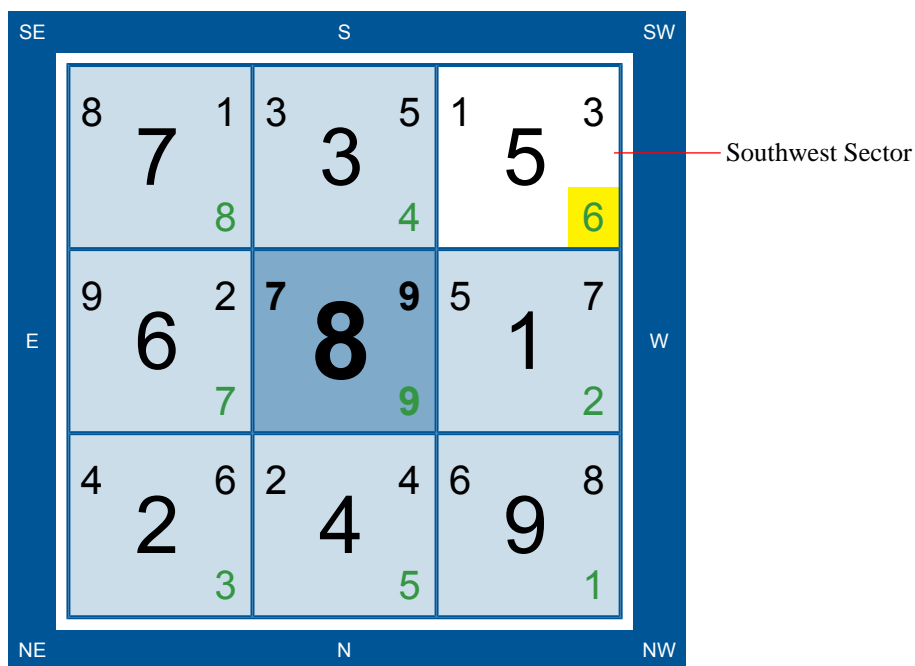

The Southwest sector of your property has the 1-3 combination in the Natal Flying Stars Chart.

The Annual Star that is present in this sector for the year is the #6 White Star. The positive aspects of the #6 White Star can bring about an increase in your status and authority, and also promote your reputation and good name. It can indicate power that is both bestowed and obtained. The authority that is brought upon by the positive aspects of this Star can also indicate scholarly wisdom.

As such, take care so as not to injure yourself, especially the head or brain, when engaging in any physical or sporting activities. That said and done, it might actually be a good idea to participate in sports or any sort of activities that include moving about, in order to minimize the risk of being affected by stress or depression.

# 8 SECTORS OF THE PROPERTY

## Northwest Sector

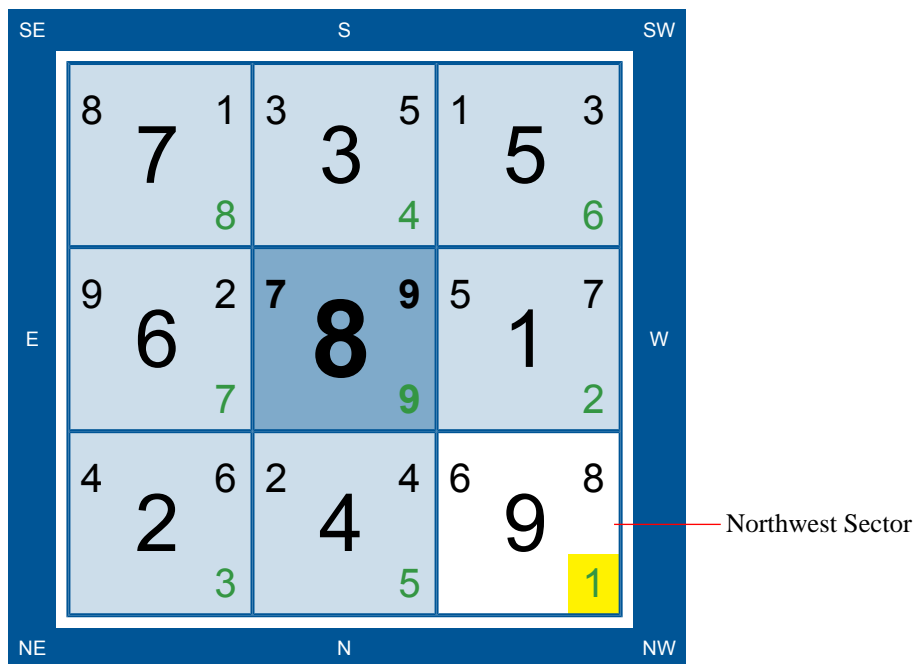

The Northwest sector of your property has the 6-8 combination in the Natal Flying Stars Chart.

For this sector, the Annual Star that is present here for the year is the #1 White Star. Known as the star of nobility, this star is also sometimes called the Greedy Wolf Star. This star is linked to good name, reputation, and status, and heralds positive new beginnings or ventures. It also represents thoughts, emotions, and feelings. When the #1 White is untimely, or activated by negative external forms, it can lead to emotional or psychological disturbance and instability. It can also lead to health troubles like insomnia, kidney problems, and food poisoning.

When analysed in combination with the Natal Chart, we can see that as long as the external environment surrounding this sector is a positive one, there should be very little need for concern, where one's health prospects come into the picture. Nevertheless, it would only be prudent to continue maintaining a healthy lifestyle, in order to minimize the possibility of acquiring a kidney, bladder, urinary tract, blood or any other ailment affecting bodily fluids and the organs producing such fluids. Be forewarned that an overabundance of Water in this sector might also give rise to mental issues and problems.

# 8 SECTORS OF THE PROPERTY

## Northeast Sector

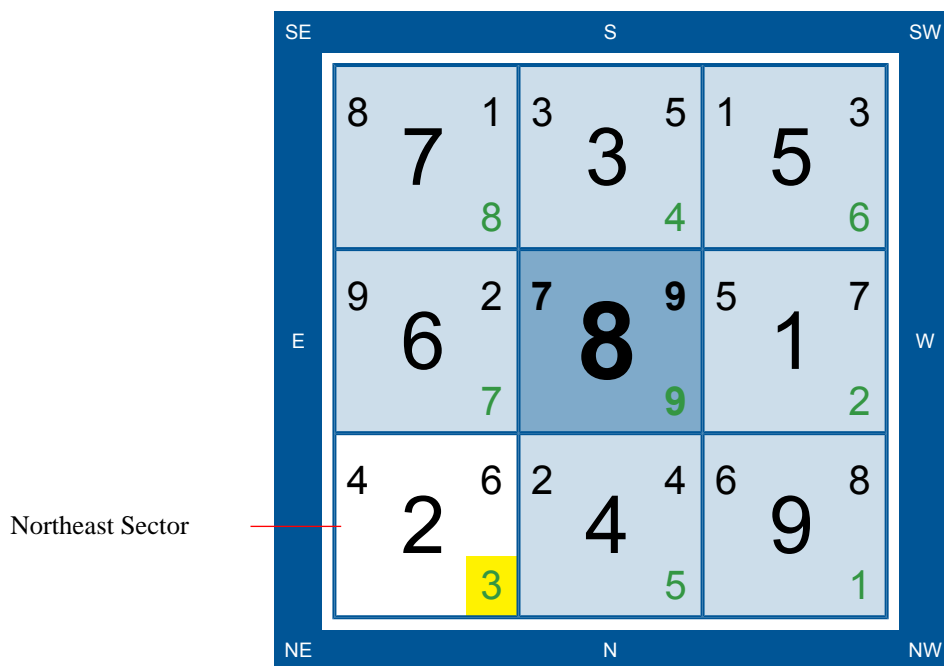

The Northeast sector of your property has the 4-6 combination in the Natal Flying Stars Chart.

This year, the #3 Jade Star flies into this sector of your property. It is a star of changes and perseverance, and is an active, vibrant star that is favourable for professional sportspeople and also for those who have jobs that involve lots of movement. When aggravated by negative landforms, it can lead to bickering and arguments. There is also the possibility of legal troubles, gossip, rumour-mongering, and misunderstandings.

Hence, do not be afraid to step forward, innovate and take the lead, especially if you pride yourself on being a go-getter who settles for nothing less than excellence. Certainly, this approach would allow sports personalities, artisans, craftsmen and all physically-talented professionals to scale even greater heights in their quest for fame and glory. Nonetheless, do not compromise your principles and integrity in your quest for success, for these very virtues distinguish man from beasts.

# WATER PLACEMENT IN YOUR PROPERTY

SE	S			SW				
8	7	1	3	5	1	3		
		8		4		6		
9	6	2	7	8	9	5	1	7
E		7		9		2		W
4	2	6	2	4	4	6	9	8
		3		5		1		
NE	N			NW				

Water has vital and significant role to play in Feng Shui implementation, as it is one of the Five Elements of Chinese Metaphysics. Qi tends to collect and gather where Water is found, and Water in turn accumulates, collects, and gathers Qi. In that same vein, Water can also be used to retain or hold in good Qi (Sheng Qi) or neutralise bad Qi (Sha Qi).

It can be said that the role of Water in Feng Shui is to activate, circulate, and move the Qi around your property. But bear in mind that Water does not actually emit Qi.

In your property, the most ideal location for a Water placement feature is in the **Southwest** sector. Placing water in this sector ensures that your property is able to properly tap into the Wealth Qi. Water can also be used in this sector to improve health, foster better relationships, resolve conflicts, and many other things.

Bear in mind that Water in Feng Shui should be slow moving and gentle, and not fast and gushing. It should be meandering, gentle, and quiet, not loud, fast-moving, and/or smelly and stagnant. When placing Water in your home, you should keep in mind the principle of proportion. The ideal amount of water you use in your property should be in direct relation to the size of your property. Therefore, an aquarium is the best-recommended solution.

However, in the years where the Annual #5 is located in this sector, avoid having a water feature in this area, as it will activate the negative energies of the 5 Yellow Star.



Based on your date of birth, which is 5 May 1956, here is an overview for the year ahead based on your Year Branch, which is Monkey.

The Monkey will enjoy relatively good Luck during the Year of the Ox. The outlook for your Career, Wealth, and Relationship Luck is good with the help of the auspicious stars that enter your Life Palace. Generally, you can look forward to a smooth year ahead with minimal bumps, but you'll need to be able to utilise the strength derived from the help of the Noble People.

You'll be able to enjoy the positive effects of three auspicious stars: the Emperor Star, the Dragon Virtue Star, and the Jade Hall Star. These stars indicate that the strength that you derive from Noble People is very strong. Certain people will want to help you, and the assistance that you get from them is genuine and sincere. This will help turn any of the negative aspects into positive ones in the end.

The Monkey can look forward to scrambling up the Career tree quite fast this year, but you'll have to continue putting in good effort! Also, this is a year to let your leadership skills shine at work, so don't be afraid to take the lead in certain matters. You will find that this might garner you a promotion or a pay raise. The Sky Happiness Star is another auspicious star that indicates the possibility of many joyous occasions, so you should allow yourself to enjoy them.

The year holds the possibility of a marriage or the birth of a child. However, there are some negative stars that the Monkey should watch out for: the Brutal Defeat Star, the Dark Sky Star, and the Death God Star. The Brutal Defeat Star indicates the possibility of things turning sour quite abruptly, and this might adversely affect your Wealth Luck. Don't be too worried, as you will have plenty of help from Noble People that will offset the effects of this star. But to be on the safe side, don't invest in the stock market.

The Dark Sky Star points to the possibility of small, minor accidents. You should be careful of the little things, especially on travel trips so keep a watchful eye on your luggage and personal belongings, and be on time for all your flights if you're going abroad (and make careful note of your travel schedules and itineraries!). With the effect of the Death God Star, you should pay careful attention to the health of the elders in your family.

*This is a computer-assisted report generated and designed to be as close as possible to a live reading. However, it is recommended that you get a detailed, live consultation from one of our Professional Feng Shui Consultants for a more comprehensive, customised reading.*



## Feng Shui Consultations

### For Residential Properties

- Initial Land/Property Assessment
- Residential Feng Shui Consultations
- Residential Land Selection
- End-to-End Residential Consultation

### For Commercial Properties

- Initial Land/Property Assessment
- Commercial Feng Shui Consultations
- Commercial Land Selection
- End-to-End Commercial Consultation

### For Property Developers

- End-to-End Consultation
- Post-Consultation Advisory Services
- Panel Feng Shui Consultant

### For Property Investors

- Your Personal Feng Shui Consultant
- Tailor-Made Packages

### For Memorial Parks & Burial Sites

- Yin House Feng Shui



## BaZi Consultations

### Personal Destiny Analysis

- Personal Destiny Analysis for Individuals
- Children's BaZi Analysis
- Family BaZi Analysis

### Strategic Analysis for Corporate Organizations

- Corporate BaZi Consultations
- BaZi Analysis for Human Resource Management

### Entrepreneurs & Business Owners

- BaZi Analysis for Entrepreneurs

### Career Pursuits

- BaZi Career Analysis

### Relationships

- Marriage and Compatibility Analysis
- Partnership Analysis

### For Everyone

- Annual BaZi Forecast
- Your Personal BaZi Coach



## Date Selection Consultations

- Marriage Date Selection
- Caesarean Birth Date Selection
- House-Moving Date Selection

- Renovation & Groundbreaking Dates
- Signing of Contracts
- Official Openings
- Product Launches



## Yi Jing Assessment

### A Time-Tested, Accurate Science

• With a history predating 4 millennia, the Yi Jing - or Classic of Change - is one of the oldest Chinese texts surviving today. Its purpose as an oracle, in predicting the outcome of things, is based on the variables of Time, Space and Specific Events.

• A Yi Jing Assessment provides specific answers to any specific questions you may have about a specific event or endeavor. This is something that a Destiny Analysis would not be able to give you.

Basically, what a Yi Jing Assessment does is focus on only ONE aspect or item at a particular point in your life, and give you a calculated prediction of the details that will follow suit, if you undertake a particular action. It gives you an insight into a situation, and what course of action to take in order to arrive at a satisfactory outcome at the end of the day.

Please Contact YGC for a personalized Yi Jing Assessment!



**Name (Mr./Mrs./Ms.):**

---

---

**Contact Details:**

Tel : 

---

Fax : 

---

Mobile : 

---

E-mail : 

---

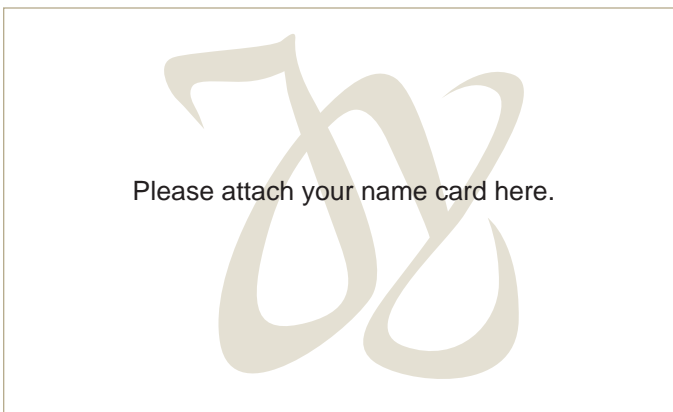

**What Type of Consultation Are You Interested In?**

- Feng Shui    BaZi    Date Selection    Yi Jing

**Please tick if applicable:**

- Are you a Property Developer looking to engage Yap Global Consulting?
- Are you a Property Investor looking for tailor-made packages to suit your investment requirements?

**Thank you for completing this form.**

Please send it back to us at:

**MALAYSIA**

19-3, The Boulevard, Mid Valley City,  
59200 Kuala Lumpur, Malaysia  
Tel : +603-2284-1213  
Fax : +603-2284-2213  
Email : consultation@joeyyap.com

**SINGAPORE**

14, Robinson Road # 13-00  
Far East Finance Building,  
Singapore 048545  
Tel : +65-6494 9147  
Email : singapore@joeyyap.com

**AUSTRALIA**

Unit 3 / 61 Belmont Avenue,  
Belmont WA 6104. Australia.  
Tel : + 618-9467 3626  
Fax : +618-9479 3388  
Email : australia@joeyyap.com

All rights reserved worldwide. Copyright © 2009 by Joey Yap.